

(X) OUTSING

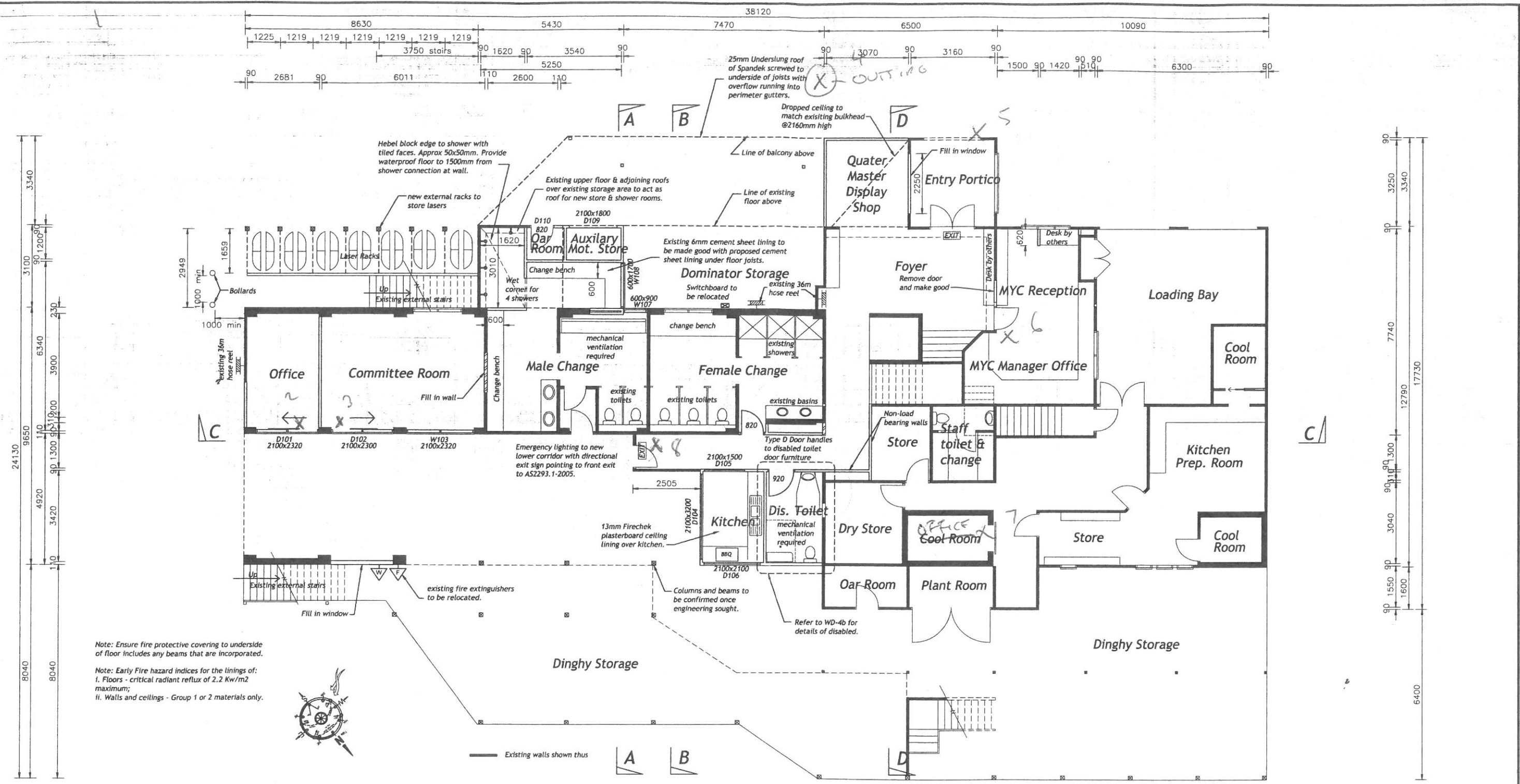

Note: Ensure fire protective covering to underside of floor includes any beams that are incorporated.
 Note: Early Fire hazard indices for the linings of:
 i. Floors - critical radiant reflux of 2.2 Kw/m² maximum;
 ii. Walls and ceilings - Group 1 or 2 materials only.

Note: Due to this being a renovation, contractors must take extra care to verify all details and dimensions on site before commencing any work or making any shop drawings.

NOTE: ALL DIMENSIONS AND CONSTRUCTION DETAILS TO BE VERIFIED ONSITE. ANY DISCREPANCIES TO BE REPORTED IMMEDIATELY TO THIS OFFICE.

Area of Addition added to lower footprint 68.14sq.m. (7.33sq's)

Proposed Ground Floor Plan

Warning - These Drawings are protected by copyright laws and remain the property of Graeme Alexander Homes. They must not be copied or altered without permission.

These Drawings are the Drawings referred to in the Contract dated and We, the Owners, agree that this set of Drawings complies with our requirements. We accept that any alterations to this set of Drawings will be a variation at the Owner's expense.
 Signed: _____ Dated: _____

graeme alexander homes pty ltd
 Cnr Watt Rd & Woodbyne Cr, Morningson 3931
 www.gahomes.com.au

morningson
 1300 301 055

REGISTERED
 Building Practitioner

bdqv
 Building Designers
 Association of Victoria

Revision Schedule		
No.	Description	Date

Morningson Yacht Club

Preliminary Working Drawings

Schnapper Point Drive, Morningson
 Melway Map 104 C9

Soil Classification to be confirmed onsite
WD-2b

Drawn by NS
 Copyright Graeme Alexander Homes Pty Ltd Scale @A2 1:100